

























CM280 SERIES TELESCOPIC CRANE

## AREA OF OPERATION

Deductions from rated loads for load handling devices supplied by Manitex

Auxiliary block	50 lbs. (22,7 kg)
Auxiliary sheave	50 lbs. (22,7 kg)
Overhaul ball	See overhaul ball mfg. nameplate
Load blocks	See block mfg. nameplate
Hose reel	260 lbs. (117,9 kg)
Swing around jib	See load chart

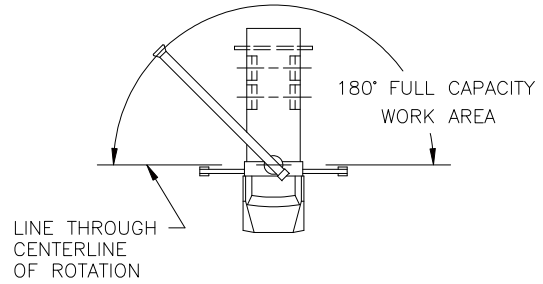

**WARNING:** Lifting off the main boom point while the jib is erected is not intended nor approved.

## REEVING DIAGRAMS

ALLOWABLE LINE PULL							<h3>WARNING</h3> <p>ANTI-TWO-BLOCK SYSTEM MUST BE IN GOOD OPERATING CONDITION BEFORE OPERATING CRANE.</p> <p>REFER TO THE OWNER'S MANUAL.</p> <p>KEEP AT LEAST 3 WRAPS OF LOAD LINE ON THE DRUM AT ALL TIMES.</p> <p>9/16" 6X25 IWRC (3.5:1 SF) - 29750 LBS MIN BREAKING STRENGTH</p> <p>9/16" ROT RESISTANT (5.0:1 SF) - 38500 LBS MIN BREAKING STRENGTH</p>
1 PART LINE	2 PART LINE	3 PART LINE	4 PART LINE	5 PART LINE	6 PART LINE	7 PART LINE	
<p>OVERHAUL BALL</p>	<p>SINGLE SHEAVE BLOCK</p>	<p>SINGLE SHEAVE BLOCK</p>	<p>TRIPLE SHEAVE BLOCK</p>	<p>TRIPLE SHEAVE BLOCK AUXILIARY BLOCK</p>	<p>TRIPLE SHEAVE BLOCK AUXILIARY SHEAVE AUXILIARY BLOCK</p>	<p>TRIPLE SHEAVE BLOCK AUXILIARY SHEAVE AUXILIARY BLOCK</p>	
8500 LBS	17000 LBS	25500 LBS	34000 LBS	42500 LBS	51000 LBS	56000 LBS	
7700 LBS	15400 LBS	23100 LBS	30800 LBS	38500 LBS	46200 LBS	53900 LBS	

## LMI OPERATING CODES

Code	Crane Configuration	Outrigger Configuration
#1	Main Boom	Fully Extended
#2	Fixed Jib	Fully Extended
#3	Telescopic Jib - Retracted	Fully Extended
#4	Telescopic Jib - Extended	Fully Extended
#5	Personnel lifting platform on main boom	Fully Extended
#6	Personnel lifting platform on fixed jib	Fully Extended
#7	Personnel lifting platform on tele. jib - Retracted	Fully Extended
#8	Personnel lifting platform on tele. jib - Extended	Fully Extended
#9	Main Boom	Intermediate
#10	Fixed Jib	Intermediate
#11	Telescopic Jib - Retracted	Intermediate
#12	Telescopic Jib - Extended	Intermediate
#13	Main Boom	Fully Retracted

### Warning

1. The operator must read and understand the owner's manual before operating the crane.
2. Positioning or operation of crane beyond areas shown on these charts is not intended or approved except where specified in owner's manual.
3. Loaded boom angles at specified boom lengths give only an approximation of the operating radius. The boom angle before loading should be greater to account for deflections. Do not exceed the operating radius for rated loads.
4. The operating radius shown in the jib rating chart is for fully extended boom only. When boom is not fully extended, use only loaded boom angle to determine load rating of jib.
5. For boom angles not shown on jib load rating chart, use rating of next lower boom angle.
6. For boom lengths not shown, use rating of next shorter or longer boom length, whichever is less. For radii not shown, use rating of next longer radius.
7. Crane load ratings on outriggers are based on freely suspended loads with the machine leveled and standing on a firm uniform supporting surface. No attempt shall be made to move a load horizontally on the ground in any direction.
8. Practical working loads depend on supporting surface, wind, and other factors affecting stability such as hazardous surroundings, experience of personnel, and proper handling, all of which must be taken into account by the operator.
9. The maximum load which may be telescoped is limited by hydraulic pressure, boom angle, and boom lubrication. It is safe to attempt to telescope any load within the limits of the load rating chart.
10. Lifting off the main boom point while the swing around jib is erected is not intended or approved.
11. 360° area of operation is only valid with the use of a front bumper stabilizer.

### Definitions

1. Operating radius is the horizontal distance from the axis of rotation to the center of the vertical hoist line or tackle with load applied.
2. Loaded boom angle as shown in the column head, is the included angle between the horizontal and longitudinal axes of the boom base after lifting rated load at rated radius.

Data published herein is intended as a guide only. Crane operation is subject to machine specific load charts and information.

CM280 SERIES TELESCOPIC CRANE

## TECHNICAL DESCRIPTIONS

### Boom



Boom length: Proportional boom

- 4-Section Telescopic Boom 92' (28 m)
- 3- Sheave Quick Reeve Boom Point



2892C:

- Boom max. tip height 102 ft. 3 in. (31 m)
- Boom min. tip height 39 ft. 2 in. (12 m)



Boom angle (min/max): -10° / 80°

### Rotation



Ball-bearing swing circle with external gear  
Double-reduction planetary gearbox driven by hydraulic motor



Slewing brake: Spring-applied pressure released parking brake



Slewing speed: 0 - 1.5 rpm  
Boom rotation: 372° non-continuous

### Outriggers



Outriggers A-Frame

- A-frame, to outer edge of pad: 23.2 ft. (7.07 m)



Outriggers Out-Down

- Out & Down 22'



Stabilizer Out-Down, center to center

- Out & down 13 ft. 11 in. (4.2 m)

### Hoist, Rope and Hook



Maximum theoretical line-speed:  
300 fpm (91 mpm)



Maximum theoretical bottom-layer line pull:  
11,500 lbs. ( 5,216 kg)



Main winch cable diameter: 9/16 in.  
(14.3 mm) EIPS IWRC Wire rope.



Line length: 300 ft. (91.44 m)



Main Winch Motor: 2 speed Gear type hydraulic motor activated electrically.  
Combined flows for high speed operation.



Hook & ball: 5 T (4.5 mt) capacity hook with heavy-duty swivel and weight is provided for single line operation.

### Hydraulics



Direct mounted PTO with SAE B input and SAE BB output

3-Section Gear Pump standard CCW Rotation

Hydraulic reservoir capacity:  
70 Gallons (265 liter)

Pump sections @ 2000 rpm with 100 psi

- Shaft end pump: 32.4 GPM (123 lpm)
- Center pump: 20.6 GPM (79 lpm)
- Cover end pump: 10 GPM (38 lpm)

### Operator aids



LMI with crane functions cut-offs for over-load protection.

- External Wired anti-two block system.

## Control System



Dual operating stations are equipped with four single-lever crane controls arranged in accordance with ANSI B30.5 standards. Fully proportional control valves. Each station includes:

- Individual control levers for each outrigger and stabilizer
- Engine start and stop
- Electronic foot throttle
- Signal horn
- Boom angle indicator
- Beverage holder
- Load chart with range diagram and mount for removable LMI display

## Electrical System

State-of-the-art, weather-resistant components throughout. Hermetically sealed enclosure includes power in relays and circuit status LEDs.

## Mounting System

Pedestal sub-frame and stabilizers are mounted to chassis by threaded rods and clamp plates. Sub-frame: Torsion resistant, rigid 4-plate design mounted under crane full length of truck frame. Rear under-ride protection: Standard on factory mounted cranes. Boom rest: Heavy-duty fabrication, easily removed.

## Options

### Flatbeds

- 22 ft. (6.7 m) Wood Bed
- 22 ft. (6.7 m) Steel Bed
- 22 ft. (6.7 m) Heavy Hauler 3/16 in. Steel
- 20 ft. (6 m) Wood Bed
- 20 ft. (6 m) Steel Bed

## Options

### Jib

2892C:

- 1 section fixed jib 26 ft. (7.9 m)
- 2 section telescopic jib 26 ft. – 46 ft. (7.9 m – 14 m)

### Max. Tip Height with Extension



2892C:

- Max. tip height with extension: 148 ft. 2 in. (45.2 m)
- Max. tip height with extension retracted: 128 ft. 6 in. (39.2 m)

### Hoist, Rope and Hook



9/16 in. (14.3 mm) rotation resistant rope

### Hydraulics



- 3 Section Vane Pump, CCW or CW
- FBS – Front Bumper Stabilizer
  - Hydraulic Oil cooler
  - Hose Reel

### 2-Person Baskets



2-person man basket - steel

- Non-rotating (600 lbs. cap.) - Steel
- 2 Person Gravity Level with Hydraulic Brake Steel (1200 lbs. cap.)
- 2 Person Quick Attached Aluminum Rotating Basket (1200 lbs. cap.) Main boom

### Operator Aids



- 4-Function radio remote crane control system
- Hycas System available with Radio Load Cell for Jib overload protection only

### Tool Box & Bulkhead

- 24 in. L x 18 in. W x 18 in. H - Steel (610 mm L x 457 mm W x 457 mm H)
- 48 in. L x 24 in. W x 24 in. H - Aluminum (1219 mm L x 610 mm W x 610 mm H)
- Bulkhead: 24 in. (610 mm)

To learn more about this model, call 414-764-9200 or visit [giuffre.com](http://giuffre.com) today!

**Manitex**



# CM280

28-ton (25.5 mt) TELESCOPIC CRANE  
CM280 SERIES PRODUCT GUIDE

**UPTime**

UPTime is the Manitex commitment to complete support of thousands of units working every day.

**MANITEX**  
3000 South Austin Avenue  
Georgetown, Texas 78626  
1-877-314-3390 | [www.Manitex.com](http://www.Manitex.com)

MTX-CM280-PC-EN-V3-0315



AVAILABLE AT:

**GIUFFRE.COM**

**GIUFFRE BROS CRANES INC.**

6635 SOUTH 13TH ST. - MILWAUKEE, WI 53221  
414-764-9200 • 877-321-3710



#1--- MAIN BOOM #5--- PERSONNEL LIFTING PLATFORM ON MAIN BOOM  
 #2--- FIXED JIB #6--- PERSONNEL LIFTING PLATFORM ON FIXED JIB  
 #3--- TELESCOPIC JIB-RETRACTED #7--- PERSONNEL LIFTING PLATFORM ON TELESCOPIC JIB-RETRACTED  
 #4--- TELESCOPIC JIB-EXTENDED #8--- PERSONNEL LIFTING PLATFORM ON TELESCOPIC JIB-EXTENDED

To learn more about this model, call 414-764-9200 or visit giuffre.com today!

ALLOWABLE LINE PULL							WARNING
1 PART LINE	2 PART LINE	3 PART LINE	4 PART LINE	5 PART LINE	6 PART LINE	7 PART LINE	
							<p>ANTI-TWO-BLOCK SYSTEM MUST BE IN GOOD OPERATING CONDITION BEFORE OPERATING CRANE.</p> <p>REFER TO THE OWNER'S MANUAL.</p> <p>KEEP AT LEAST 3 WRAPS OF LOAD LINE ON THE DRUM AT ALL TIMES.</p>
8500 LBS	17000 LBS	25500 LBS	34000 LBS	42500 LBS	51000 LBS	56000 LBS	
7400 LBS	14800 LBS	22200 LBS	29600 LBS	37000 LBS	44400 LBS	51800 LBS	<p>9/16" 6X25 IWRC (3.5:1 SF) - 29750 LBS MIN BREAKING STRENGTH</p> <p>9/16" ROT RESISTANT (5.0:1 SF) - 37000 LBS MIN BREAKING STRENGTH</p>
<p><b>DEDUCTIONS FROM RATED LOADS FOR LOAD HANDLING DEVICES SUPPLIED BY MANITEX</b></p> <p>AUXILIARY BLOCK ----- 50 LBS            AUXILIARY SHEAVE ----- 50 LBS            OVERHAUL BALL ----- SEE OVERHAUL BALL MFR. NAMEPLATE            LOAD BLOCK ----- SEE BLOCK MFR. NAMEPLATE            HOSE REEL ----- 140 LBS            SWING AROUND JIB ----- SEE LOAD CHART</p> <p><b>WARNING</b>            LIFTING OFF THE MAIN BOOM POINT WHILE THE SWING AROUND JIB IS ERECTED IS NOT INTENDED OR APPROVED.</p>							

- CRANE LOAD RATINGS ON OUTRIGGERS ARE BASED ON FREELY SUSPENDED LOADS WITH THE MACHINE LEVELED AND STANDING ON A FIRM UNIFORM SUPPORTING SURFACE. NO ATTEMPT SHALL BE MADE TO OPERATE AT AN ANGLE ON THE CRANE AND ANY DEVIATION.
  - PRACTICAL WORKING LOADS DEPEND ON SUPPORTING SURFACE, WIND, AND OTHER FACTORS AFFECTING STABILITY SUCH AS HAZARDOUS SURROUNDINGS, EXPERIENCE OF PERSONNEL, AND PROPER HANDLING, ALL OF WHICH MUST BE TAKEN INTO ACCOUNT BY THE OPERATOR.
  - THE MAXIMUM LOAD WHICH MAY BE TELESCOPED IS LIMITED BY HYDRAULIC PRESSURE, BOOM ANGLE, AND BOOM LUBRICATION. IT IS SAFE TO ATTEMPT TO TELESCOPE ANY LOAD WITHIN THE LIMITS OF THE LOAD RATING CHART. BOOM MUST BE FULLY RETRACTED AGAINST BOOM STOPS AT ALL TIMES WHEN LIFTING MINIMUM BOOM LENGTH CAPACITY LOADS.
- INFORMATION**
- DEDUCTIONS MUST BE MADE FROM RATED LOADS FOR STOWED JIB, OPTIONAL ATTACHMENTS, HOOKS, AND LOAD-BLOCKS (SEE DEDUCTION CHART). WEIGHTS OF SLINGS AND ALL OTHER LOAD HANDLING DEVICES SHALL BE CONSIDERED A PART OF THE LOAD.
  - CRANE LOAD RATINGS WITH OUTRIGGERS ARE BASED ON OUTRIGGERS AND STABILIZERS EXTENDED AND SET WITH MACHINE LEVELED.
  - LOAD RATINGS ABOVE THE HEAVY LINE ARE STRUCTURALLY LIMITED CAPACITIES. LOAD RATINGS BELOW THE HEAVY LINE ARE STABILITY LIMITED CAPACITIES AND DO NOT EXCEED 85% OF TIPPING.
- DEFINITIONS**
- OPERATING RADIUS IS THE HORIZONTAL DISTANCE FROM THE AXIS OF ROTATION TO THE CENTER OF THE VERTICAL HOIST LINE OR TACKLE WITH LOAD APPLIED.
  - LOADED BOOM ANGLE AS SHOWN IN THE COLUMN HEADED BY  $\alpha$ , IS THE INCLUDED ANGLE BETWEEN THE HORIZONTAL AND LONGITUDINAL AXES OF THE BOOM BASE AFTER LIFTING RATED LOAD AT RATED RADIUS.



**MODEL 2892C**

CRANE MEETS ANSI B30.5 REQUIREMENTS

7300097-001 NR

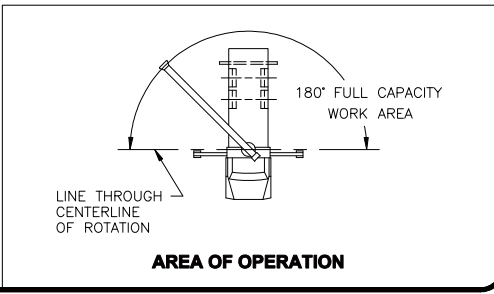

GIUFFRE.COM



AVAILABLE AT:

**GIUFFRE.COM**

**GIUFFRE BROS CRANES INC.**

6635 SOUTH 13TH ST. - MILWAUKEE, WI 53221

414-764-9200 • 877-321-3710

#1--- MAIN BOOM #5--- PERSONNEL LIFTING PLATFORM ON MAIN BOOM  
 #2--- FIXED JIB #6--- PERSONNEL LIFTING PLATFORM ON FIXED JIB  
 #3--- TELESCOPIC JIB-RETRACTED #7--- PERSONNEL LIFTING PLATFORM ON TELESCOPIC JIB-RETRACTED  
 #4--- TELESCOPIC JIB-EXTENDED #8--- PERSONNEL LIFTING PLATFORM ON TELESCOPIC JIB-EXTENDED

To learn more about this model, call 414-764-9200 or visit giuffre.com today!

ALLOWABLE LINE PULL							WARNING
1 PART LINE	2 PART LINE	3 PART LINE	4 PART LINE	5 PART LINE	6 PART LINE	7 PART LINE	
8500 LBS	17000 LBS	25500 LBS	34000 LBS	42500 LBS	51000 LBS	56000 LBS	
7400 LBS	14800 LBS	22200 LBS	29600 LBS	37000 LBS	44400 LBS	51800 LBS	

**WARNING**

ANTI-TWO-BLOCK SYSTEM MUST BE IN GOOD OPERATING CONDITION BEFORE OPERATING CRANE.

REFER TO THE OWNER'S MANUAL.

KEEP AT LEAST 3 WRAPS OF LOAD LINE ON THE DRUM AT ALL TIMES.

**DEDUCTIONS FROM RATED LOADS FOR LOAD HANDLING DEVICES SUPPLIED BY MANITEX**

AUXILIARY BLOCK ----- 50 LBS  
 AUXILIARY SHEAVE ----- 50 LBS  
 OVERHAUL BALL ----- SEE OVERHAUL BALL MFR. NAMEPLATE  
 LOAD BLOCK ----- SEE BLOCK MFR. NAMEPLATE  
 HOSE REEL ----- 140 LBS  
 SWING AROUND JIB ----- SEE LOAD CHART

**WARNING**  
 LIFTING OFF THE MAIN BOOM POINT WHILE THE SWING AROUND JIB IS ERRECTED IS NOT INTENDED OR APPROVED.

- CRANE LOAD RATINGS ON OUTRIGGERS ARE BASED ON FREELY SUSPENDED LOADS WITH THE MACHINE LEVELED AND STANDING ON A FIRM UNIFORM SUPPORTING SURFACE. NO ATTEMPT SHALL BE MADE TO OPERATE AT AN ANGLE ON THE CRANE AND ANY DEVIATION.
  - PRACTICAL WORKING LOADS DEPEND ON SUPPORTING SURFACE, WIND, AND OTHER FACTORS AFFECTING STABILITY SUCH AS HAZARDOUS SURROUNDINGS, EXPERIENCE OF PERSONNEL, AND PROPER HANDLING, ALL OF WHICH MUST BE TAKEN INTO ACCOUNT BY THE OPERATOR.
  - THE MAXIMUM LOAD WHICH MAY BE TELESCOPED IS LIMITED BY HYDRAULIC PRESSURE, BOOM ANGLE, AND BOOM LUBRICATION. IT IS SAFE TO ATTEMPT TO TELESCOPE ANY LOAD WITHIN THE LIMITS OF THE LOAD RATING CHART. BOOM MUST BE FULLY RETRACTED AGAINST BOOM STOPS AT ALL TIMES WHEN LIFTING MINIMUM BOOM LENGTH CAPACITY LOADS.
- INFORMATION**
- DEDUCTIONS MUST BE MADE FROM RATED LOADS FOR STOWED JIB, OPTIONAL ATTACHMENTS, HOOKS, AND LOAD-BLOCKS (SEE DEDUCTION CHART). WEIGHTS OF SLINGS AND ALL OTHER LOAD HANDLING DEVICES SHALL BE CONSIDERED A PART OF THE LOAD.
  - CRANE LOAD RATINGS WITH OUTRIGGERS ARE BASED ON OUTRIGGERS AND STABILIZERS EXTENDED AND SET WITH MACHINE LEVELED.
  - LOAD RATINGS ABOVE THE HEAVY LINE ARE STRUCTURALLY LIMITED CAPACITIES. LOAD RATINGS BELOW THE HEAVY LINE ARE STABILITY LIMITED CAPACITIES AND DO NOT EXCEED 85% OF TIPPING.
- DEFINITIONS**
- OPERATING RADIUS IS THE HORIZONTAL DISTANCE FROM THE AXIS OF ROTATION TO THE CENTER OF THE VERTICAL HOIST LINE OR TACKLE WITH LOAD APPLIED.
  - LOADED BOOM ANGLE AS SHOWN IN THE COLUMN HEADED BY  $\alpha$ , IS THE INCLUDED ANGLE BETWEEN THE HORIZONTAL AND LONGITUDINAL AXES OF THE BOOM BASE AFTER LIFTING RATED LOAD AT RATED RADIUS.



**MODEL 2892C**

CRANE MEETS ANSI B30.5 REQUIREMENTS

7300097-001 NR

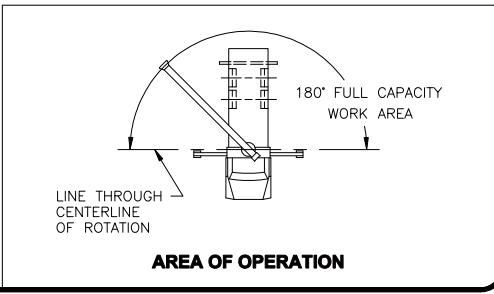

AVAILABLE AT:

**GIUFFRE.COM**

**GIUFFRE BROS CRANES INC.**

6635 SOUTH 13TH ST. - MILWAUKEE, WI 53221

414-764-9200 • 877-321-3710